

imperial_{2.0}

imperial_{2.5}

imperial_{3.5}

SUPERIA

stilo_{grad}

atlanta

gridsky

offset

Índice Geral

1	TIPOLOGIAS	PÁG. TI-01 e TI-02
2	PERFIS	PÁG. PE-01 a PE-06
3	COMPONENTES	PÁG. CO-01 e CO-13

1 TIPOLOGIAS

Janelas de correr

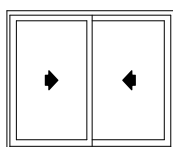

Janela de correr 2 folhas

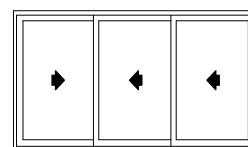

Janela de correr 3 folhas

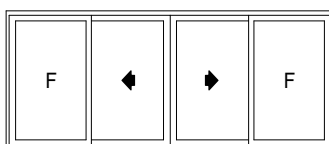

Janela de correr 4 folhas

Portas de correr

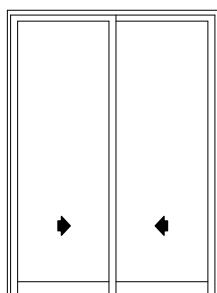

Porta de correr 2 folhas

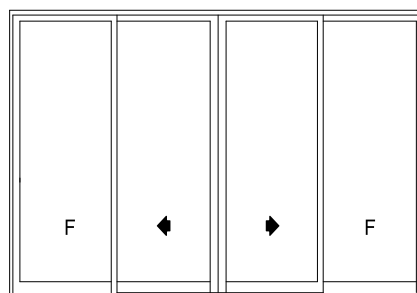

Porta de correr 4 folhas

2 PERFIS

perfil	página
6201	PE-03
KBV-010	PE-06
LS-4501	PE-06
LS-4502	PE-06
LS-4504	PE-03
LS-4505	PE-03
LS-4506	PE-05
LS-4507	PE-04
LS-4508	PE-04
LS-4509	PE-05
LS-4531	PE-04
LS-4532	PE-05
SI-3716	PE-06
SI-3748	PE-05

LS-4504

1,435 Kg/m

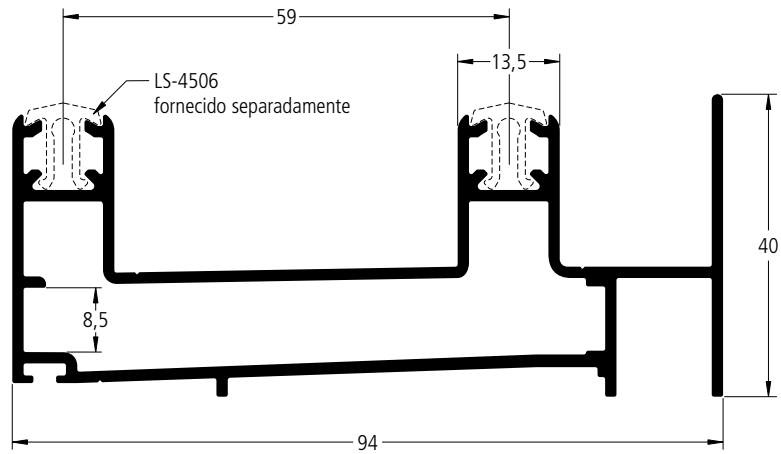

LS-4505

0,881 Kg/m

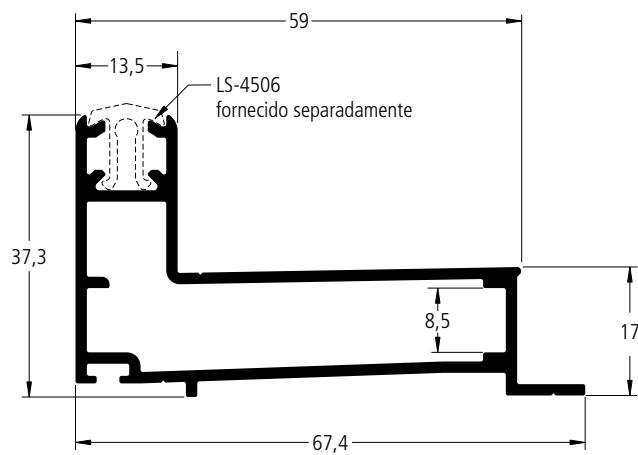

6201

0,547 Kg/m

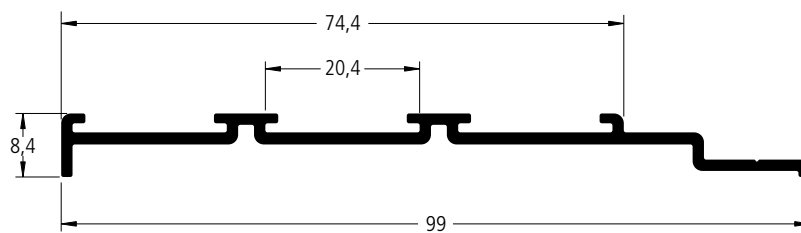

LS-4507

1,744 Kg/m

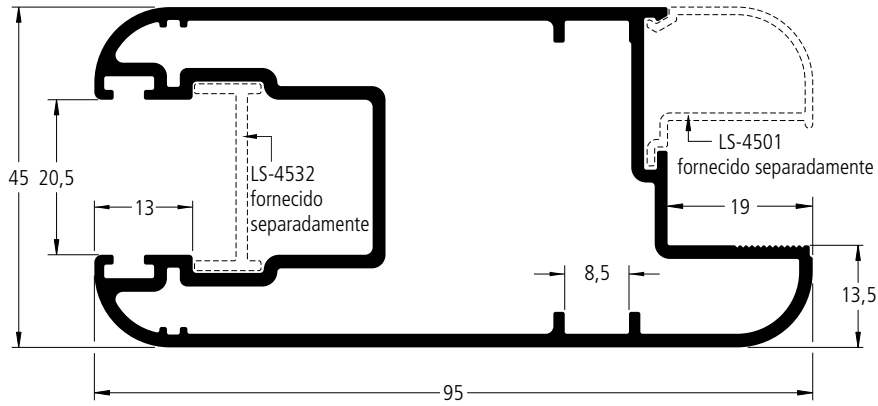

LS-4531

0,511 Kg/m

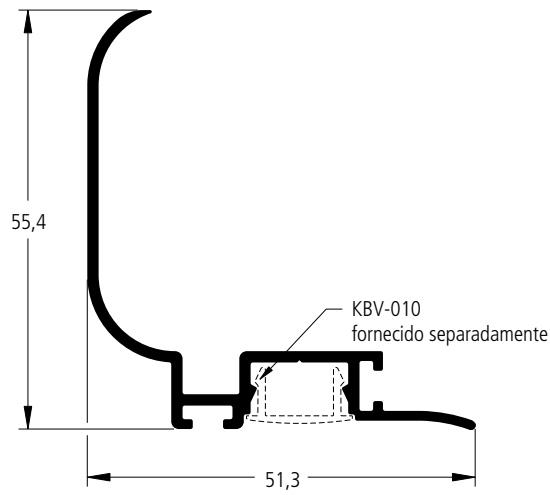

LS-4508

1,172 Kg/m

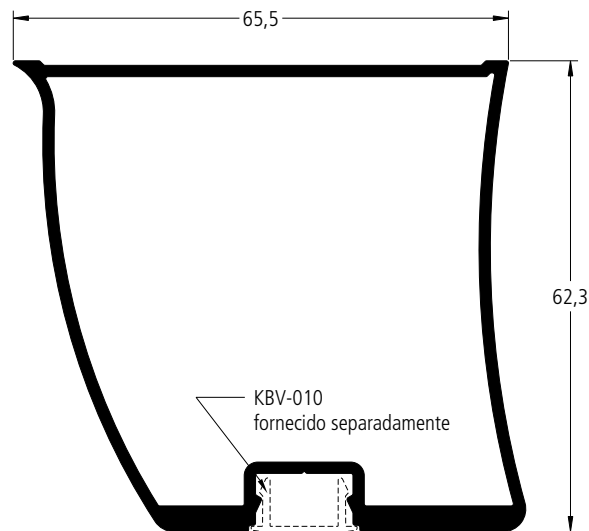

LS-4509

0,199 Kg/m

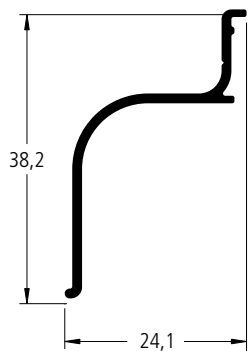

SI-3748

0,236 Kg/m

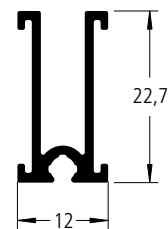

LS-4506

0,097 Kg/m

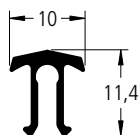

LS-4532

0,152 Kg/m

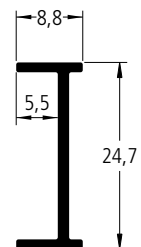

SI-3716

0,226 kg/m

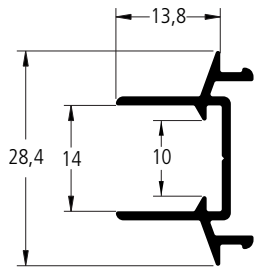

KBV-010

0,070 Kg/m

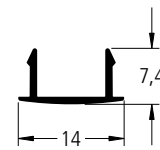

LS-4502

0,175 Kg/m

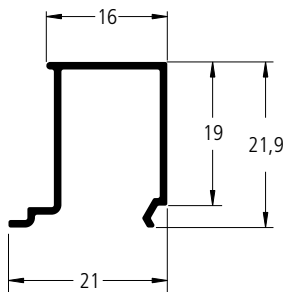

LS-4501

0,164 Kg/m

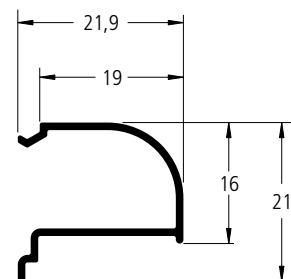

3 COMPONENTES

POP-ABL - ver tabela	
Rebite de repuxo cabeça abaulada	
material	= alumínio
acabamento	= natural

Código	Dimensões
POP-ABL-3212	3,2 x 12,8 mm
POP-ABL-4012	4,0 x 12,8 mm
POP-ABL-4812	4,8 x 12,8 mm

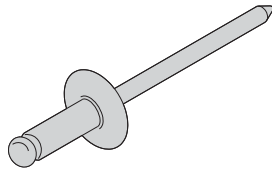

PRX+XAA-4213-NAT	
Parafuso AA Ø 4,2 x 13 mm	
material	= aço Inox
acabamento	= natural
embalagem	= pacote c/ 100 peças

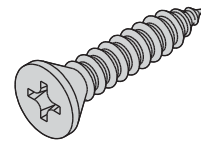

PRX+PAA - ver tabela	
Parafuso auto atarrachante cabeça panela fenda cruzada	
material	= aço Inox
acabamento	= natural

Código	Dimensões
PRX+PAA-3909-NAT	3,9 x 9,0 mm
PRX+PAA-4213-NAT	4,2 x 13,0 mm
PRX+PAA-4225-NAT	4,2 x 25,0 mm
PRX+PAA-4232-NAT	4,2 x 32,0 mm
PRX+PAA-4238-NAT	4,2 x 38,0 mm
PRX+PAA-4250-NAT	4,2 x 50,0 mm
PRX+PAA-4813-NAT	4,8 x 13,0 mm
PRX+PAA-4850-NAT	4,8 x 50,0 mm

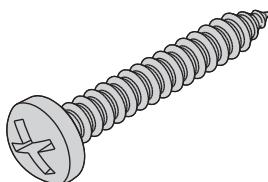

PRX+PPG - ver tabela	
Parafuso auto atarrachante cabeça panela fenda cruzada ponta guia	
material	= aço Inox
acabamento	= natural

Código	Dimensões
PRX+PPG-4832-NAT	4,8 x 32,0 mm
PRX+PPG-4850-NAT	4,8 x 50,0 mm

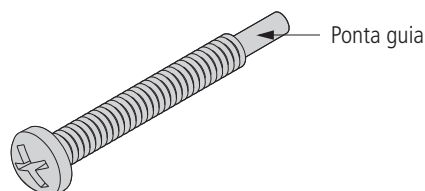

BMT-PRE-0190-PRT

Presilha do arremate

material = nylon

acabamento = cor preta

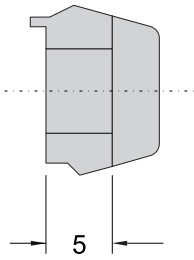
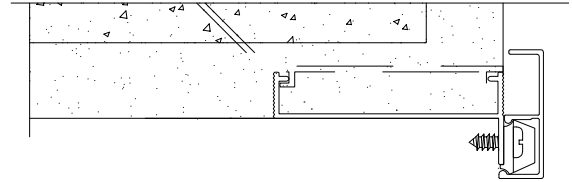
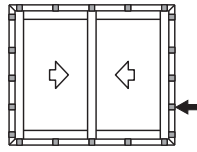

VISTA
sem escala

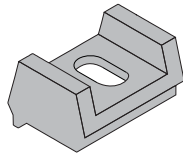

PERSPECTIVA
sem escala

DETALHE DE UTILIZAÇÃO
escala 1:2

BMT-PRE-5465-NAT

Presilha do arremate 5465

material = alumínio

acabamento = natural

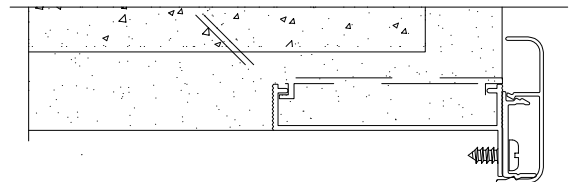
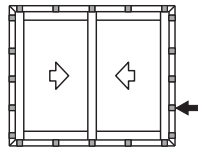

P ril 5465

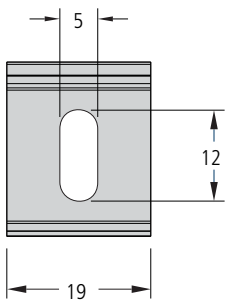

VISTA
escala 1:1

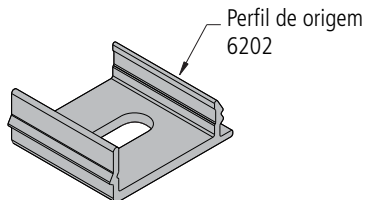

PERSPECTIVA
sem escala

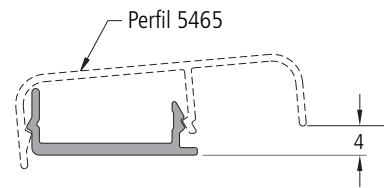

Primeiro estágio de parada

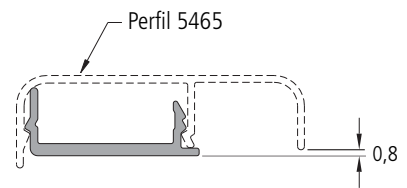

Segundo estágio de parada

DETALHES DE UTILIZAÇÃO
escala 1:1

BMT-GUI-0043-PRT

Guia em nylon - (Fermax)

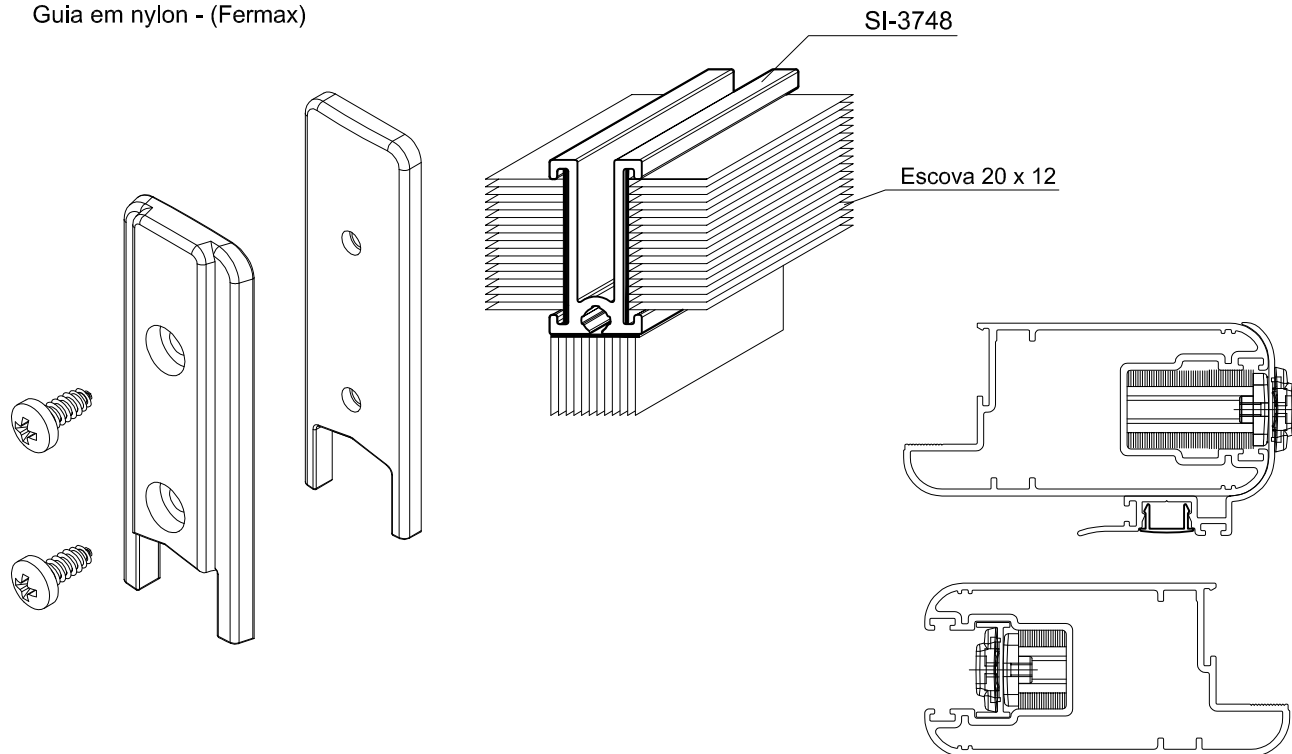

*EMBALAGEM: Pacote com 10 peças

DRENO E VEDAÇÃO SUPERIOR

Perfil 6201 fornecido em barras de 6000mm mais escova 20 x 12mm

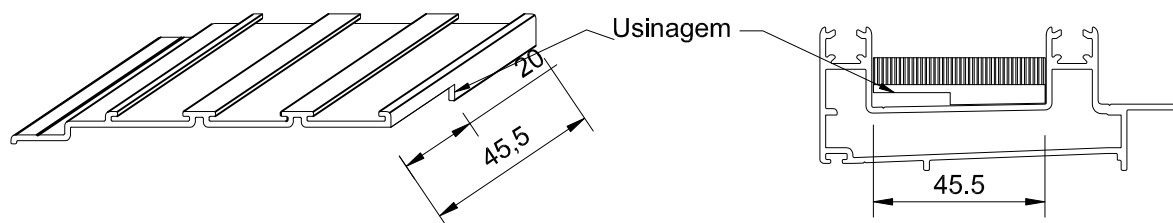
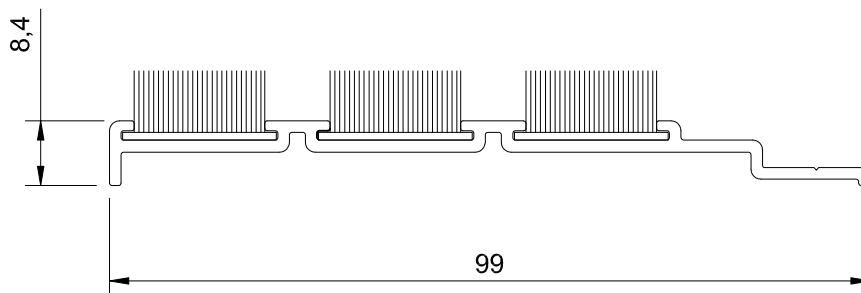

BMT-GUA-2024-PRT

Guarnição flocada

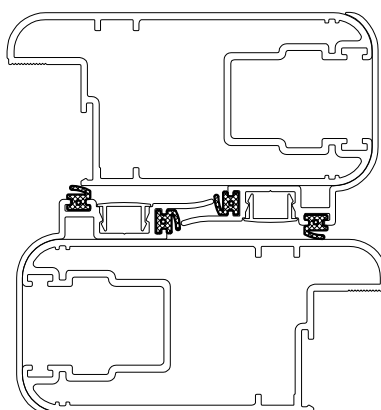
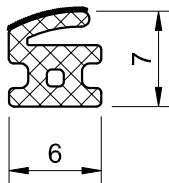

*EMBALAGEM: Rolo de 50 metros

BMT-EVD6507-PRT

Escova Periferica

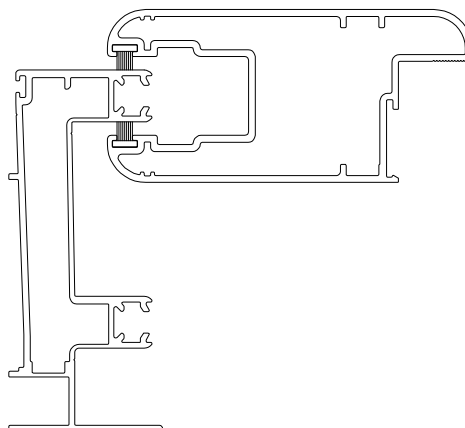
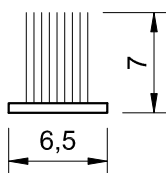

*EMBALAGEM: Rolo de 50 metros

BMT-GUA-2876-PRT
Guarnição Periferica

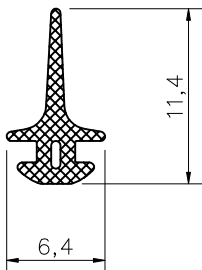

Esc.: 2 : 1

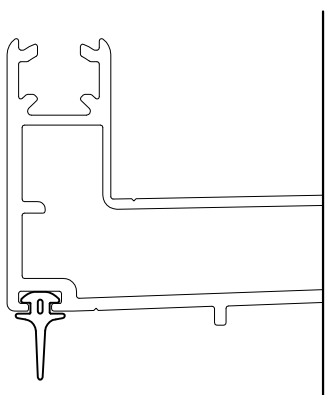

*EMBALAGEM: Rolo de 50 metros

BMT-BAT-0398
Batedeira em nylon

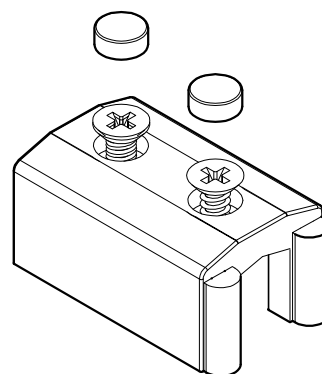

*EMBALAGEM: Pacote com 10 peças

BMT-EVD-2012-PRT

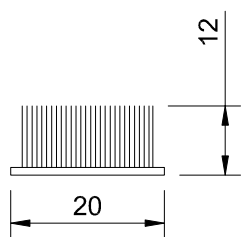

SI-3748

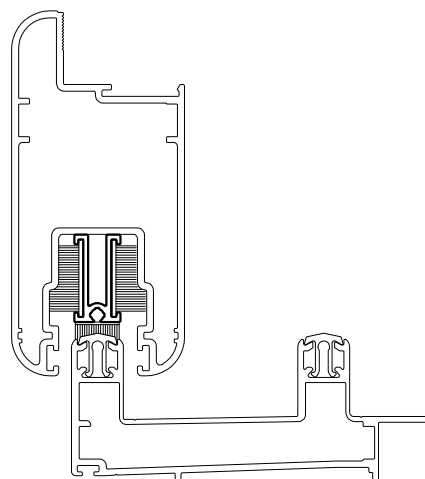
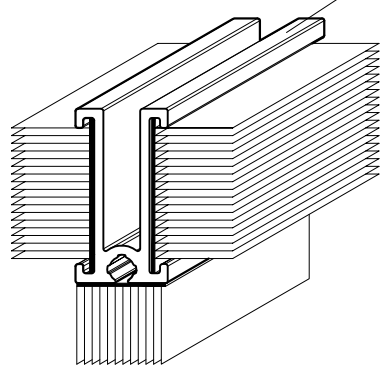

*EMBALAGEM: Rolo de 50 metros

BMT-ROL-8901-CRR

Roldana 40Kg por roldana - Antiga ASI-399

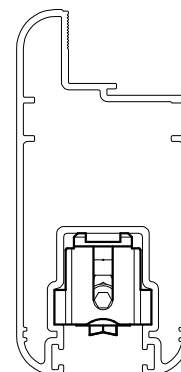
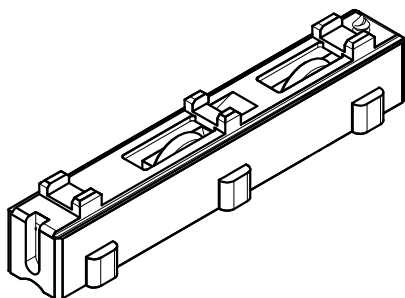

*EMBALAGEM: Pacote com 2 peças

BMT-ROL-9001-CRR

Roldana Strong 60Kg por roldana - Antiga ASI-397

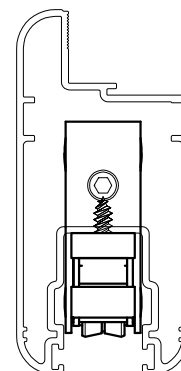
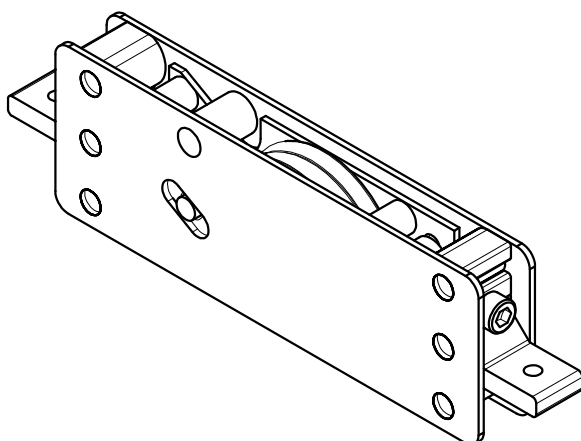

*EMBALAGEM: Pacote com 2 peças

BMT-ROL-9002-CRR

Roldana Strong 120Kg por roldana - Antiga ASI-398

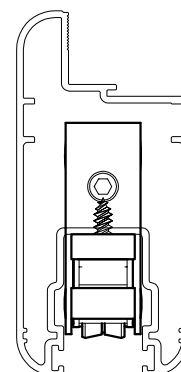
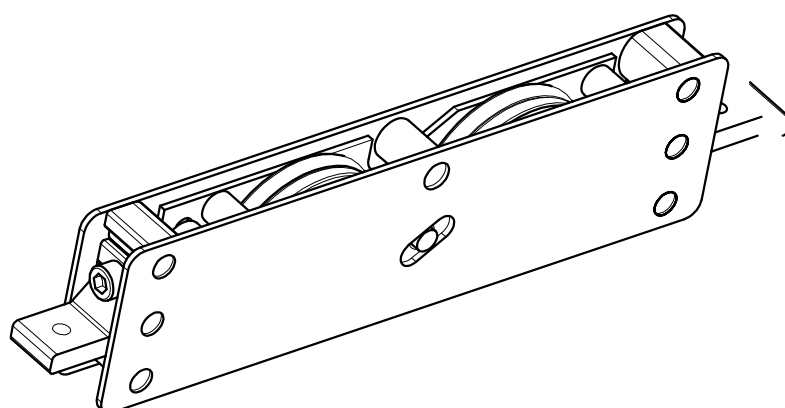

*EMBALAGEM: Pacote com 2 peças

BMT-FEC-7001

Cremona 1 ponto

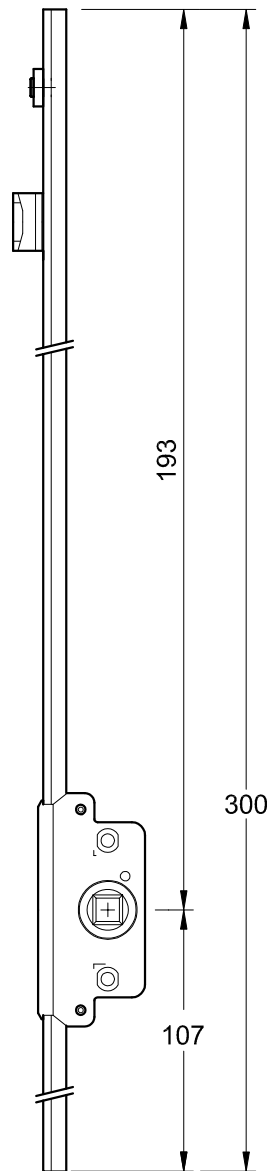

BMT-FEC-7012

Cremona 2 pontos

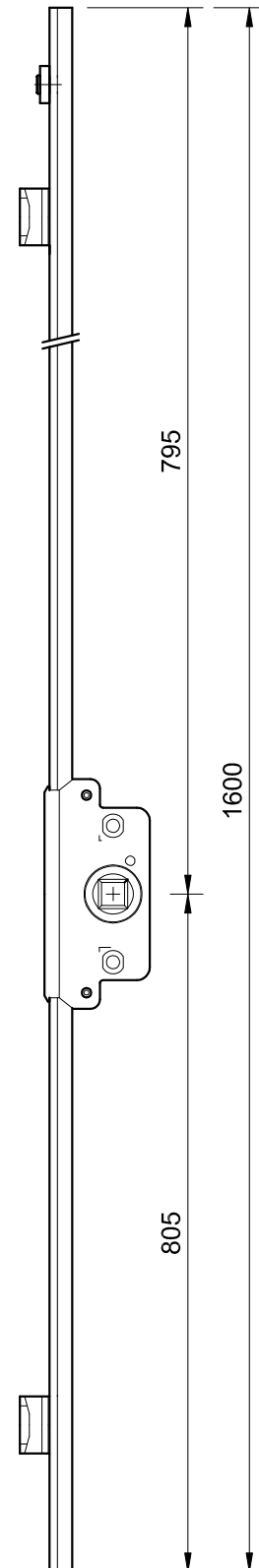

BMT-MAC-0007 (Dir.)
 BMT-MAC-0017 (Esq.)

Maçaneta deslocada

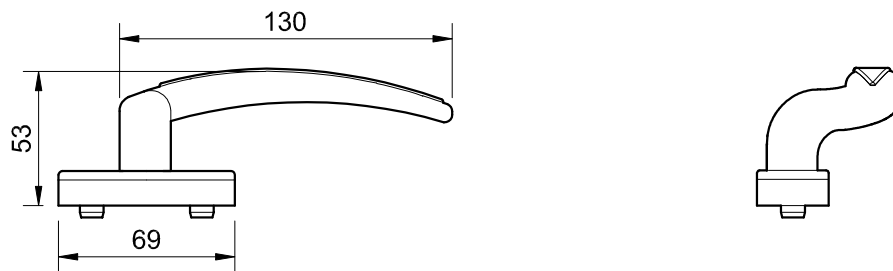

BMT-HAS-5001-NTR

Haste

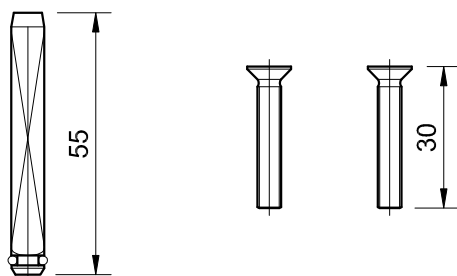

BMT-CFC-0003

Contra fecho

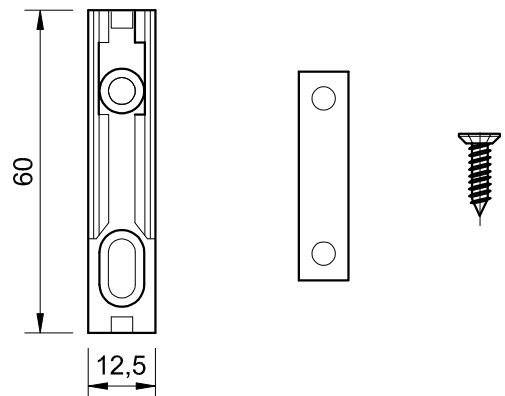

Sugestão para instalação
 Cremona Udinese

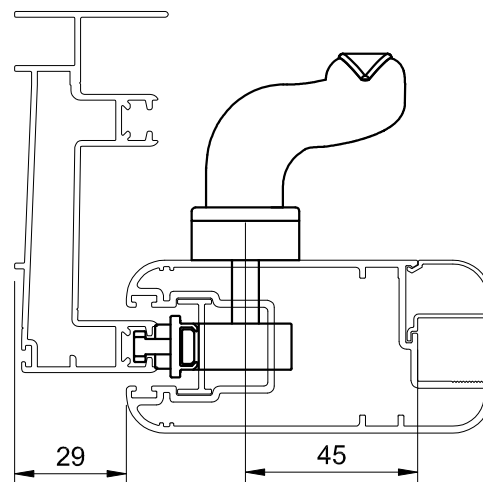

CNX-0580-ALN-NAK

Conector 41mm

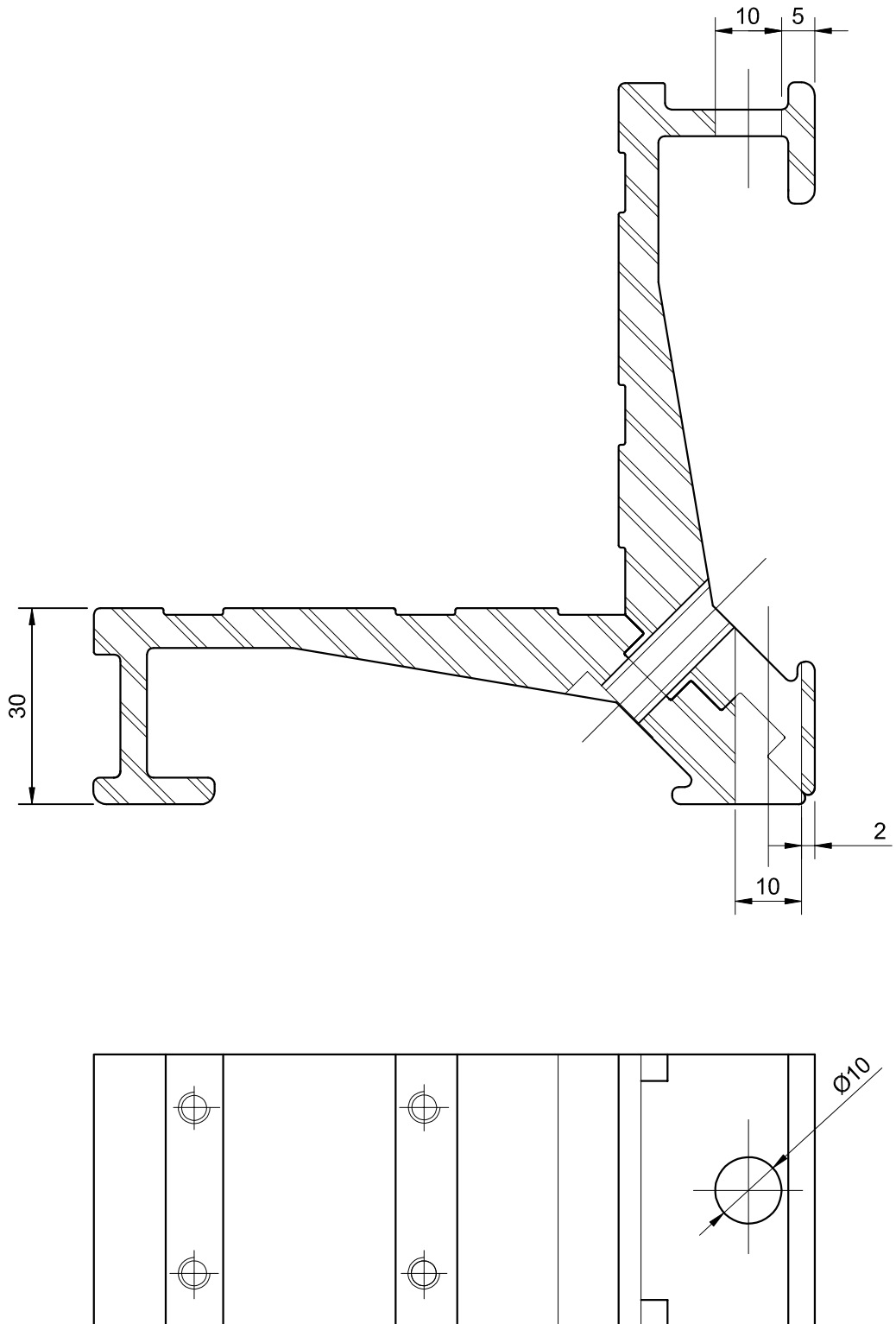

BMT-CAL-0374-PRT

Calço de compensação da folha fixa
Nylon cor preta

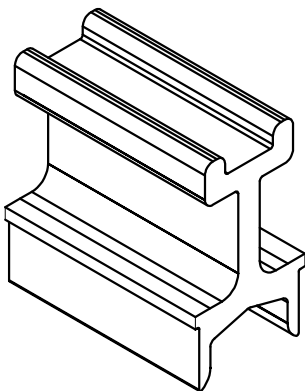

PERSPECTIVA S/ ESCALA

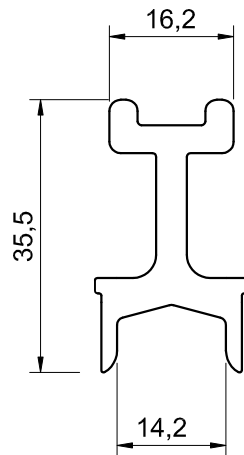

VISTA ESCALA 1-1

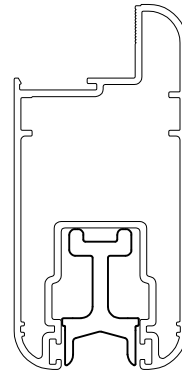

*EMBALAGEM: Pacote com 20 peças

BMT-GRA-0897-AGV

Grapa para contramarcos BP-060/BP-384
Aço Zincado

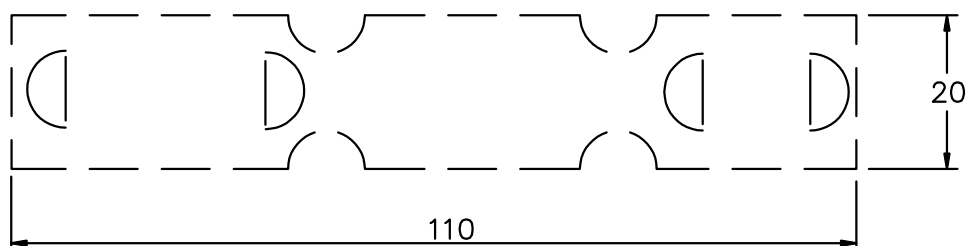
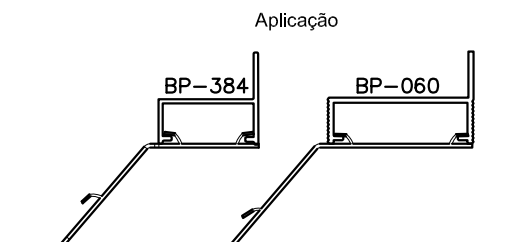

BMT-GUA-2377-PRT

Gaxeta cunha
E.P.D.M. cor preta

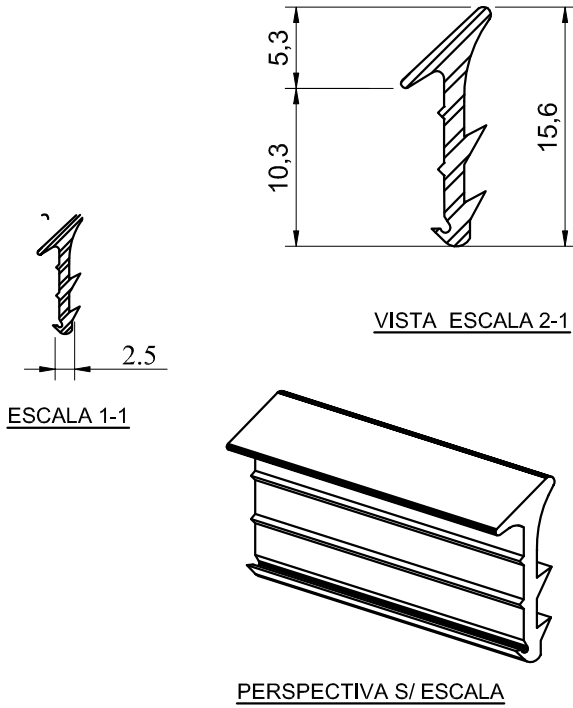

*EMBALAGEM: Rolo com 50 mts.

BMT-GUA-2378-PRT

Gaxeta cunha
E.P.D.M. cor preta

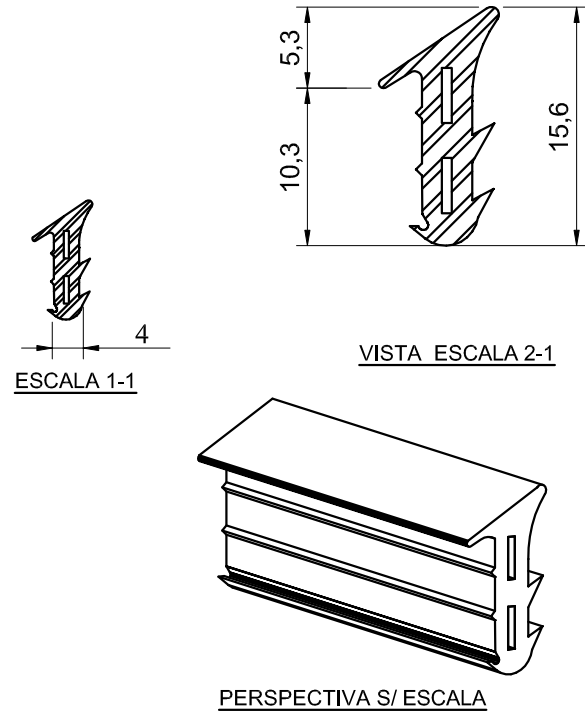

*EMBALAGEM: Rolo com 50 mts.

BMT-ESP- 1507-PVC

Guarnição externa do vidro
Espuma de PVC expandido
01 face adesiva

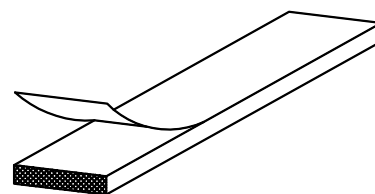
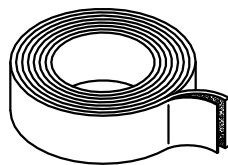

PERSPECTIVA S/ ESCALA

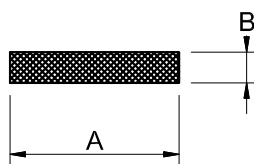

S / ESCALA

BELMETAL	A	B
BMT-ESP-1507-PVC	15 mm	7 mm

*EMBALAGEM: Rolo com 10 mts.

TABELA DE UTILIZAÇÃO DAS GUARNIÇÕES

ESP. VIDRO	GUARNIÇÃO INTERNA	GUARNIÇÃO EXTERNA
6 mm	BMT-GUA-2378-PRT	BMT-ESP-1507
8 mm	BMT-GUA-2377-PRT	BMT-ESP-1507
20 mm	BMT-GUA-2378-PRT	BMT-ESP-1507

DETALHE DE UTILIZAÇÃO

